



CHESTNUT

P R O D U C T S

FINISHING SCHOOL

Using Cut n' Polish.



1 Cut'n'Polish is a special blend of soft waxes with an ultrafine abrasive suspended within it. Use it on bare wood sanded to 240 grit to give a dust-free, final finish whilst imparting a wax finish at the same time.

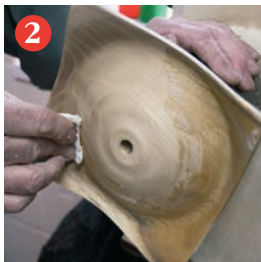

It can also be used on sealed wood to smooth the sealer, giving a bright wax finish which can be overcoated with more wax if desired.

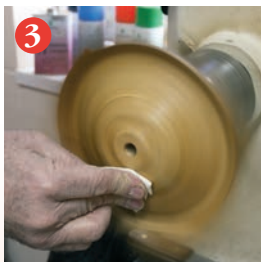

2 Apply Cut'n'Polish with the lathe stationary, wiping it over the entire surface. You'll hear the abrasive working on the surface straight away.

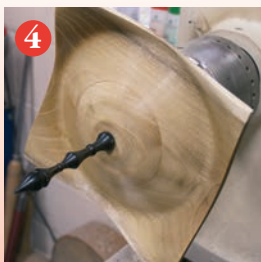

3 Leave the Cut'n'Polish thirty seconds to partially dry, then turn the lathe on and polish up using Safety Cloth. The cutting action of the abrasive will smooth the surface at the same time. Use a new area of the cloth as buffing proceeds until a satisfactory shine is achieved.



4 Cut'n'Polish can be left as a finish on its own, or can be overcoated with WoodWax 22 or any of the waxes in our range for a brighter shine.

5 Cut'n'Polish enhances the finish without changing the colour of the original item.

More information available from your local stockists or contact us at:

PO Box 260, Stowmarket, IP14 9BX

Tel: 01473 890118

mailroom@chestnutproducts.co.uk

www.chestnutproducts.co.uk

