



CHESTNUT

P R O D U C T S

FINISHING SCHOOL

Decorated Vase

WITH SHEILA AND STEVE



1 Turn and hollow out the vase and sand to a smooth finish. Apply a couple of coats of Spirit Stain (we used Royal Blue) using a brush or airbrush. This should be done with the lathe stationery.

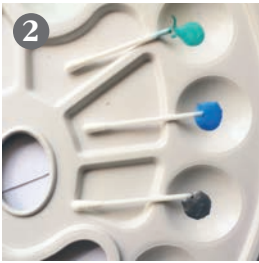

2 For extra decoration we used Turquoise and Azure Iridescent Paints along with the Silver Metallic Paint. Plastic handled cotton buds with the end cut off were perfect for applying the paint to form the pattern.



3 The dots were added free hand in a Turquoise, Silver and Azure repeat pattern using the cut down cotton buds. With a little practice we were able to make some of the dots larger in size to add to the pattern.



4 The vase was given a couple of coats of Acrylic Gloss Lacquer on the lathe once the paints were dry. The vase was then parted off and the bottom finished.



5 Although the vase is only small, the design subtly adds extra interest and decoration. Using the Acrylic Gloss Lacquer highlights the depth of the base colour and makes the Iridescent and Metallic Paints really pop.

See our YouTube channel for more tips!

More information available from your local stockists or contact us at:

PO Box 260, Stowmarket, IP14 9BX

Tel: 01473 890118

mailroom@chestnutproducts.co.uk

www.chestnutproducts.co.uk

